

HPT CPJ 25

CLARK Hand Pallet Truck HPT CPJ25
2500 kg

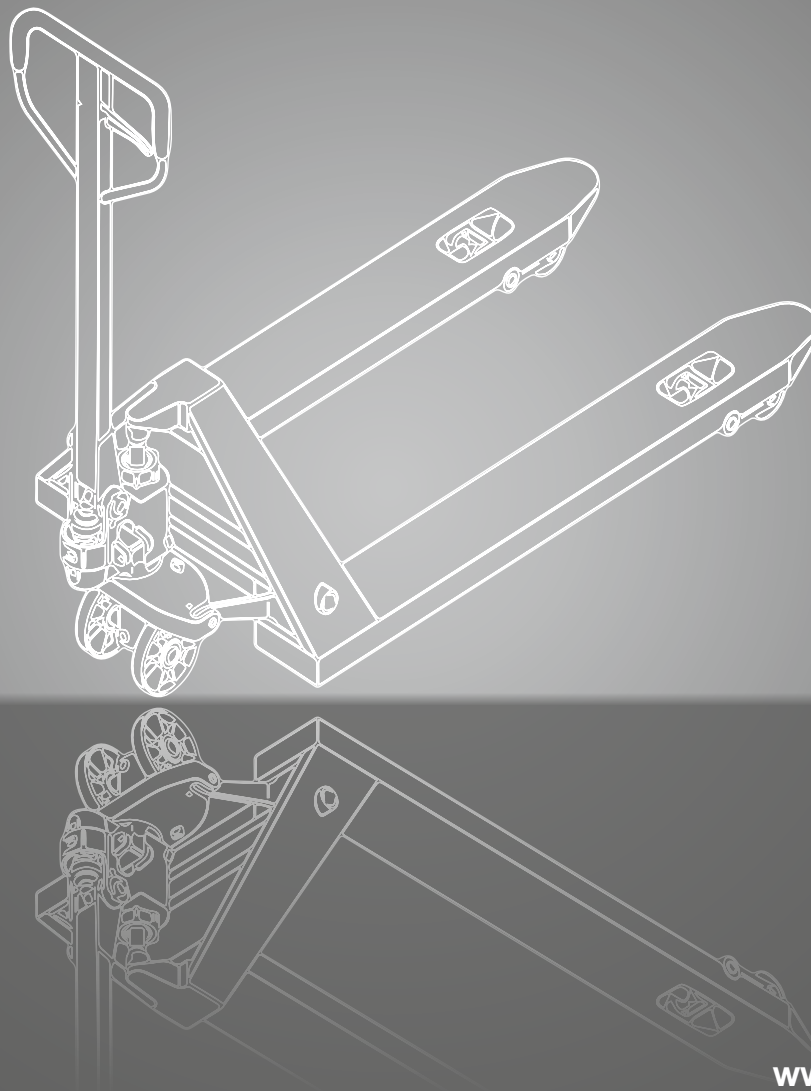

DIMENSIONS

HPT CPJ25

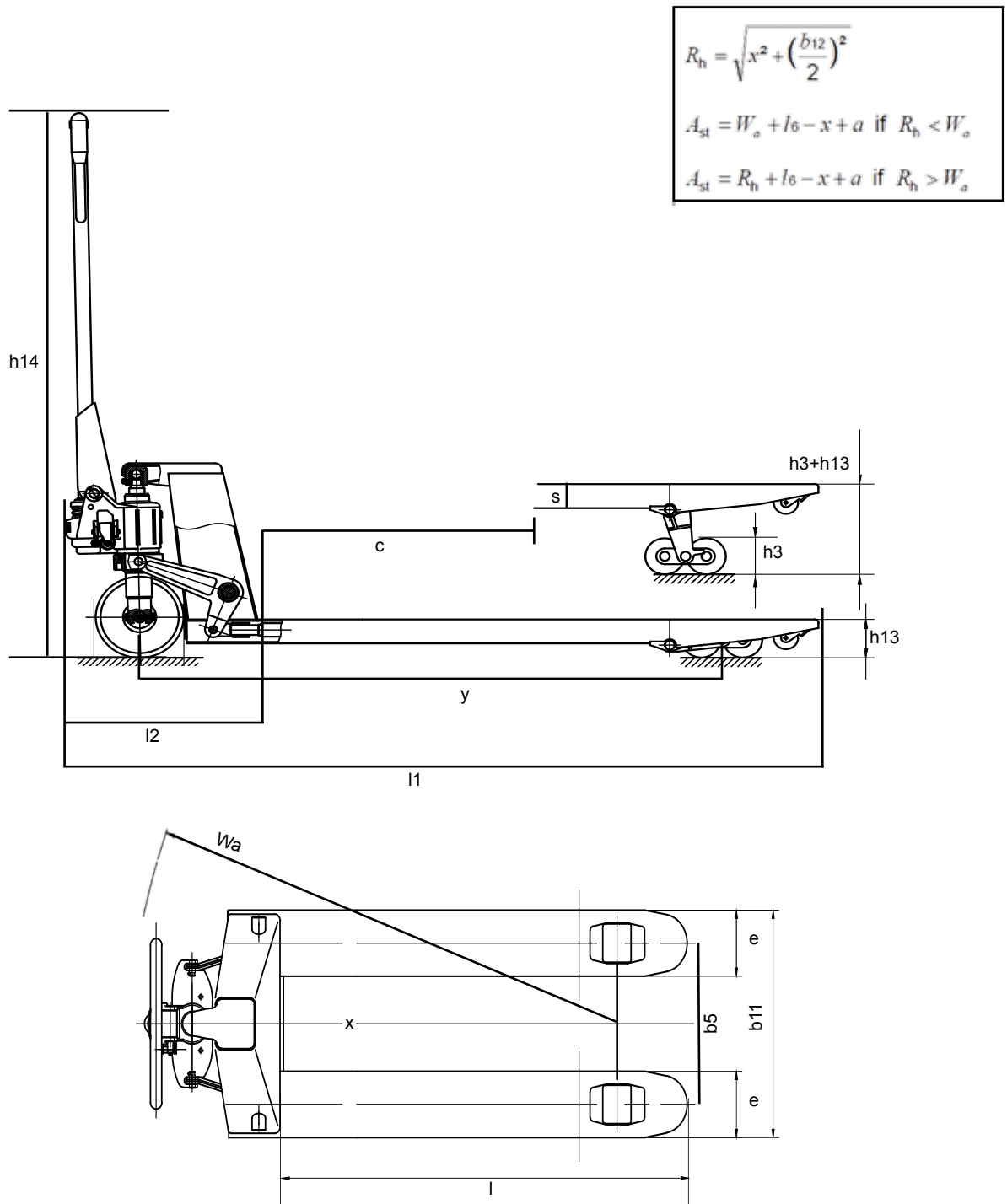

For corresponding data see
Specification Chart.

SPECIFICATIONS

Product Specification acc. to VDI 2198

Specifications	1.1	Manufacturer (Abbreviation)	CLARK
	1.2	Manufacturer's designation	HPT CPJ25
	1.3	Drive	Manual
	1.4	Operator type	Hand
	1.5	Rated capacity/rated load Q (kg)	2500
	1.6	Load centre distance c (mm)	600
	1.8	Load distance x (mm)	934
	1.9	Wheelbase y (mm)	1165
Weight	2.1	Service weight kg	68
	2.2	Axle loading, laden rear kg	-
	2.2	Axle loading, laden front kg	-
	2.3	Axle loading, unladen rear kg	-
	2.3	Axle loading, unladen front kg	-
Tyres	3.1	Tyres: Drive wheel	Rubber
	3.1	Tyres: Load wheel	Polyurethan
	3.2	Tyre size, front	200 x 50
	3.3	Tyre size, rear	80 x 70
	3.5	Wheels, number front/rear	2 / 4
	3.6	Tread, front b10 (mm)	170
	3.7	Tread, rear b11 (mm)	460
Dimensions	4.4	Lift h3 (mm)	115
	4.4	Lift height h3 + h13 (mm)	200
	4.9	Tiller arm height h14 (mm)	1230
	4.15	Height, lowered h13 (mm)	85
	4.19	Overall length l1 (mm)	1550
	4.20	Length to face of forks l2 (mm)	400
	4.21	Overall width b1 (mm)	540
	4.22	Fork dimensions s • e • l (mm)	55 x 160 x 1150
	4.25	Distance between fork-arms b5 (mm)	540
	4.32	Ground clearance, centre of wheelbase m2 (mm)	30
	4.33	Aisle width for pallets 1.000 x 1.200 sideways Ast (mm)	1443
	4.34	Aisle width for pallets 800 x 1.200 lengthways Ast (mm)	1843
	4.35	Turning radius Wa (mm)	1377

All data refer to trucks in standard design.

Performance may vary + 5 % and - 10 % due to motor and system efficiency tolerance. The performance shown represents nominal values which may be obtained under typical operating conditions of a machine. CLARK products and specifications are subject to change without notice.

HPT CPJ25

With the HPT CPJ25, CLARK offers another reliable hand pallet truck for use in industry or commercial applications. The CLARK HPT CPJ is robust, service-friendly and easy to operate. Thanks to its sturdy steel construction and a selection of different castors, it can be used on a variety of floor conditions.

High stability and operator-friendly

- Equipped with extension and retraction rollers
- Smooth running when moving, lifting and lowering
- Manoeuvrable even in the tightest of spaces thanks to the large steering angle of the drawbar
- Different fork lengths and roller designs available
- Provides high and reliable quality thanks to the use of high-quality and easy-to-maintain pumps

Durable and robust

- The sturdy frame is powder-coated and guarantees a long service life
- Pressure relief valve to protect against overloading
- Robust adjustable push bar to compensate for height differences between the forks
- Solid construction of the push bars
- Optimally designed opening area between the forks for easy loading and better protection of the rollers

Ergonomic and safe drawbar

- Low effort required to operate the hydraulics
- The sheathed tiller handle has a comfortable gripping surface for the operator
- Stepless and sensitive lowering of the rounded forks through proportional lift

Equipment		HPT CPJ25
Drive Wheel	Nylon - Commonly used standard in the industry	X
	Poly - Very quiet running for all types of applications	X
	Rubber - Good grip even on wet / slippery floors	•
Load Wheel	Nylon	X
	Poly	•

• = Standard; x = Option

CLARK Europe GmbH
Dr.-Alfred-Herrhausen-Allee 33
47228 Duisburg/Germany
Tel.: +49 (0)2065 499 13-0
Fax : +49 (0)2065 499 13-290
E-mail: Info-europe@clarkmheu.com
www.clarkmheu.com

Dealer: